



**ROBERTS COMMUNITIES**  
— FULFILLING DREAMS —



Manufactured By: **Clayton**

www.robertscommunities.com  
**A Family of Premier Manufactured Home Communities**



# RESOLUTION X

## Standard Series

 1,216 Sq Ft

 3 Bedroom

 2 Bathroom

 Kitchen Island

 Split Bedrooms

 Double Sinks in Bath

Perfect starter home for you and your family!



**512-354-3791**





# FEATURES

## Standard Series

- Hardiboard Siding
- 3/8 Sheetrock Walls
- 5/8 Floor Decking

### eBuilt ENHANCEMENTS

- 25 + Home efficiencies
- LED Lighting
- Hybrid Water Heater
- Smart Comfort By Carrier
- Lower Annual Utility Consumption

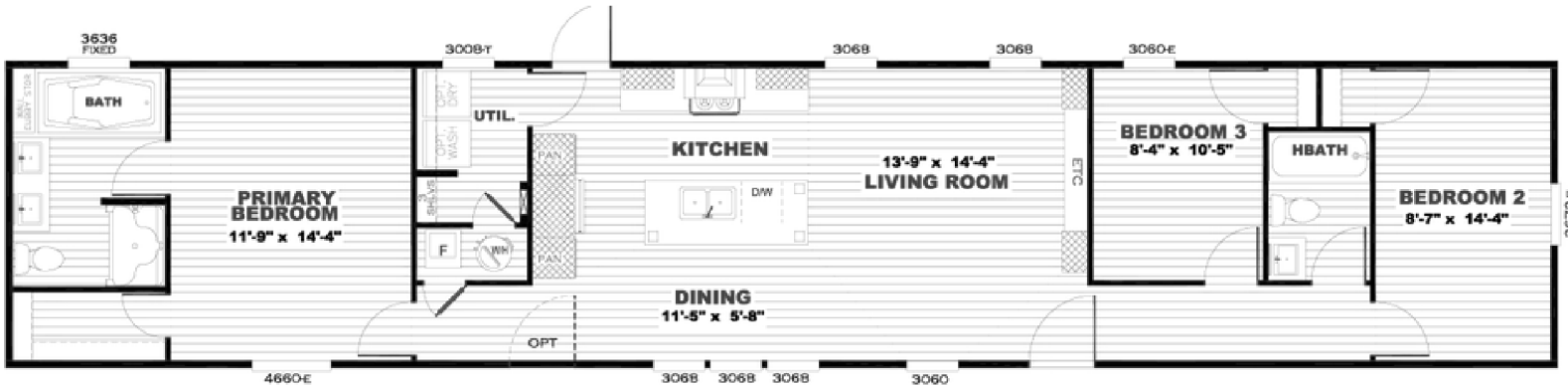

Disclaimer: Information provided is for general purposes only and subject to change without notice. Actual features and specifications may vary.



SCAN TO TOUR

### MY HOME DETAILS:

Tour Date: \_\_\_\_\_ Sales Price: \_\_\_\_\_

Sales Person: \_\_\_\_\_ Move-In Date: \_\_\_\_\_

Incentive(s): \_\_\_\_\_ Community Fee: \_\_\_\_\_

